



# ACUMULADOR HIDRONEUMÁTICO A MEMBRANA

*Diaphragm accumulator*

**Serie ELM**  
80 bar – 350 bar

CONEXIÓN AF

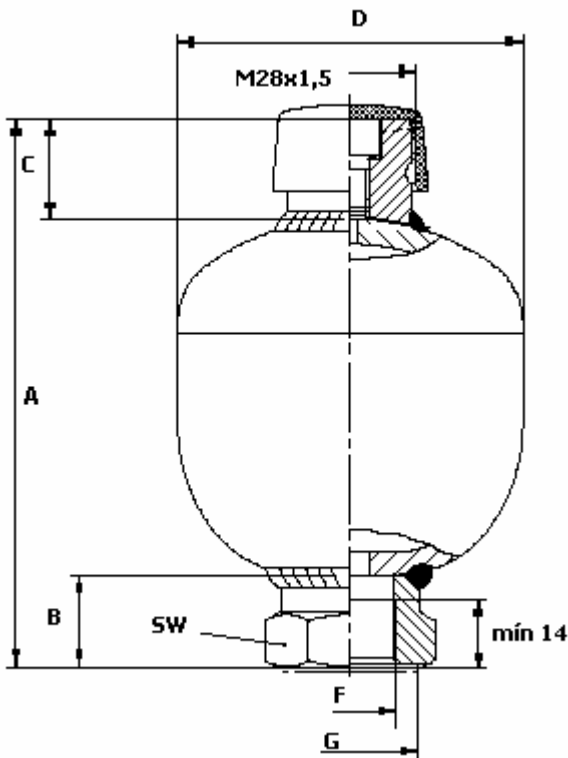

**TIPO / TYPE**

Acumulador hidroneumático no desmontable, con cuerpo de acero soldado por bombardeo electrónico. Membrana de nitrilo compatible con la mayoría de fluidos. Su construcción permite altas relaciones de compresión.

*Membrane Bladder Accumulator non-repairable with a body-electron beam welded and an elastomer diaphragm compatible with a large number of fluids. The specific profile allows a large compression ratios.*

**PRESION DE SERVICIO / WORKING PRESSURE**

Entre 80 y 350 bar (ver tabla)  
*Between 80 and 350 bar (see attached table)*

**PRESION DE HINCHADO / PRECHARGE**

Siempre con nitrógeno. Entre 0,9 de P1 y 0,12 de P2  
*Always Nitrogen. Between 0,9 x P1 and 0,12 x P2*

**TEMPERATURA DE SERVICIO / WORKING TEMPERATURE**

Entre -10° C y 80° C para construcciones estándar. Para otros rangos contáctenos.  
*Between -10°C and 80°C for standard applications. For other ranges contact us.*

**NORMATIVA / APPROVALS**

Todos los acumuladores de esta serie están aprobados y certificados de acuerdo a la Directiva 97/23/EC. Otras certificaciones bajo pedido.  
*All the accumulators of this serial fulfilled the directive 97/23/EC. Other certifications under request.*

**MONTAJE / MOUNTING**

Preferiblemente en posición vertical. Para otras posiciones consúltenos.

*It is recommended in vertical position. For other position ask us.*

**FIJACIONES / FIXATION**

Está terminantemente prohibido soldar cualquier fijación en el cuerpo. Sistemas de fijación disponibles en catálogo de accesorios.  
*It is totally prohibited to weld any fixation on the shell. Fixing systems at your disposal in Accessories Catalogue.*

CONEXIÓN CF

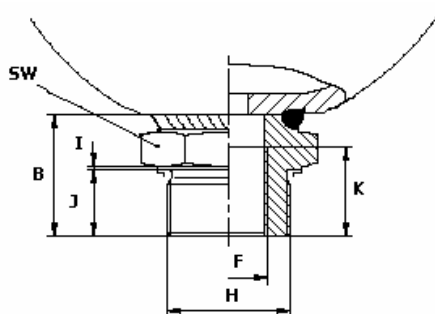

CONEXIÓN AF

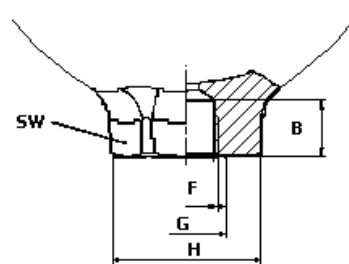



MODELO Model	FORMA	VOL. de Gas N2 Volume L	PRESIÓN Pressure Bar	Relación de Compresión Pmax/P0	Peso weight Kg	Descripción Description										
						A	B	C	SW	D	F	G	H	I	J	K
ELM 0,075/250 /00 AF	AF	0.075	250	8:1	0.7	111	20	22	32	64	1/2" G	29	---	---	---	---
ELM 0,16/250 /00 AF	AF	0.16	250	6:1	1	120	20	22	32	75	1/2" G	29	---	---	---	---
ELM 0,32/210 /00 AF	AF	0.32	210	8:1	1.4	134	20	22	32	92.5	1/2" G	29	---	---	---	---
ELM 0,5/210 /00 AF	AF	0.5	210	8:1	2	152	22	22	41	106	1/2" G	34	---	---	---	---
ELM 0,5/210 /00 CF	CF	0.5	210	8:1	2	163	33	22	41	106	1/2" G	---	M33x1,5	1	18	24
ELM 0,75/210/00 AF	AF	0.75	210	8:1	2.6	166	22	22	41	121.5	1/2" G	34	---	---	---	---
ELM 0,75/210 /00 CF	CF	0.75	210	8:1	2.6	177	33	22	41	121.5	1/2" G	---	M33x1,5	1	18	24
ELM 0,75/350 /00 AF	AF	0.75	350	8:1	4.4	173	22	22	41	128.5	1/2" G	34	---	---	---	---
ELM 0,75/350 /00 CF	CF	0.75	350	8:1	4.5	184	33	22	41	128.5	1/2" G	---	M33x1,5	---	---	---
ELM 1,0/210 /00 AF	AF	1	210	8:1	3.5	180	22	22	41	136.2	1/2" G	34	---	---	---	---
ELM 1,0/210 /00 CF	CF	1	210	8:1	3.5	191	33	22	41	136.2	1/2" G	---	M33x1,5	1	18	24
ELM 1,4/80 /90 AF	AF	1.4	80	8:1	4.2	191	22	22	41	147	1/2" G	34	---	---	---	---
ELM 1,4/140 /90 AF	AF	1.4	140	8:1	4.2	191	22	22	41	147.3	1/2" G	34	---	---	---	---
ELM 1,4/140 /90 CF	CF	1.4	140	8:1	4.2	202	33	22	41	147.3	1/2" G	---	M33x1,5	1	18	24
ELM 1,4/250 /90 AF	AF	1.4	250	8:1	6	195	22	22	41	152	1/2" G	34	---	---	---	---
ELM 1,4/250 /90 CF	CF	1.4	250	8:1	6	206	33	22	41	152	1/2" G	---	M33x1,5	1	18	24
ELM 1,4/350 /90 AF	AF	1.4	350	8:1	7.4	198	22	22	41	156	1/2" G	34	---	---	---	---
ELM 1,4/350 /90 CF	CF	1.4	350	8:1	7.5	220	20	18	41	156	1/2" G	---	M33x1,5	---	---	---
ELM 2,0/100 /90 AF	AF	2	100	6:1	3.5	240	22	22	41	144.7	1/2" G	34	---	---	---	---
ELM 2,0/250 /90 AF	AF	2	250	6:1	7.5	251	22	22	41	156	3/4" G	33	---	---	---	---
ELM 2,0/350 /90/AF	AF	2	350	6:1	11.3	219	24	18	55	180	3/4" G	34	---	---	---	---
ELM 2,0/350 /90 CF	CF	2	350	6:1	11.5	240	26	18	55	180	3/4" G	34	M45x1,5	---	---	---
ELM 2,8/250 /90 AF	AF	2.8	250	4:1	10	268	21	22	41	174	3/4" G	33	---	---	---	---
ELM 2,8/350 /90 AF	AF	2.8	350	4:1	14.3	264	23	18	55	180	3/4" G	34	---	---	---	---
ELM 2,8/350 /90 CF	CF	2.8	350	4:1	14.5	285	26	18	55	180	3/4" G	34	M45x1,5	---	---	---
ELM 3,5/250 /90 AF	AF	3.5	250	4:1	11	307	21	22	41	174	3/4" G	32	---	---	---	---
ELM 3,5/350 /90 AF	AF	3.5	350	4:1	16	304	23	18	55	180	3/4" G	34	---	---	---	---
ELM 3,5/350 /90 CF	CF	3.5	350	4:1	16.5	325	26	18	55	180	3/4" G	34	M45x1,5	---	---	---

## CODIFICACIÓN / Codification

